



520 West 25th St.  
(Between 10th & 11th Ave.)  
New York, NY 10001  
Tel: 212.627.4900  
Fax: 212.627.7079

# REHEARSAL FACILITIES



### 25th ST. MAIN ENTRANCE

TRUCK ACCESS:  
10' Wide  
14' 4" High

LOADING DOCK  
TRUCK LOAD-IN

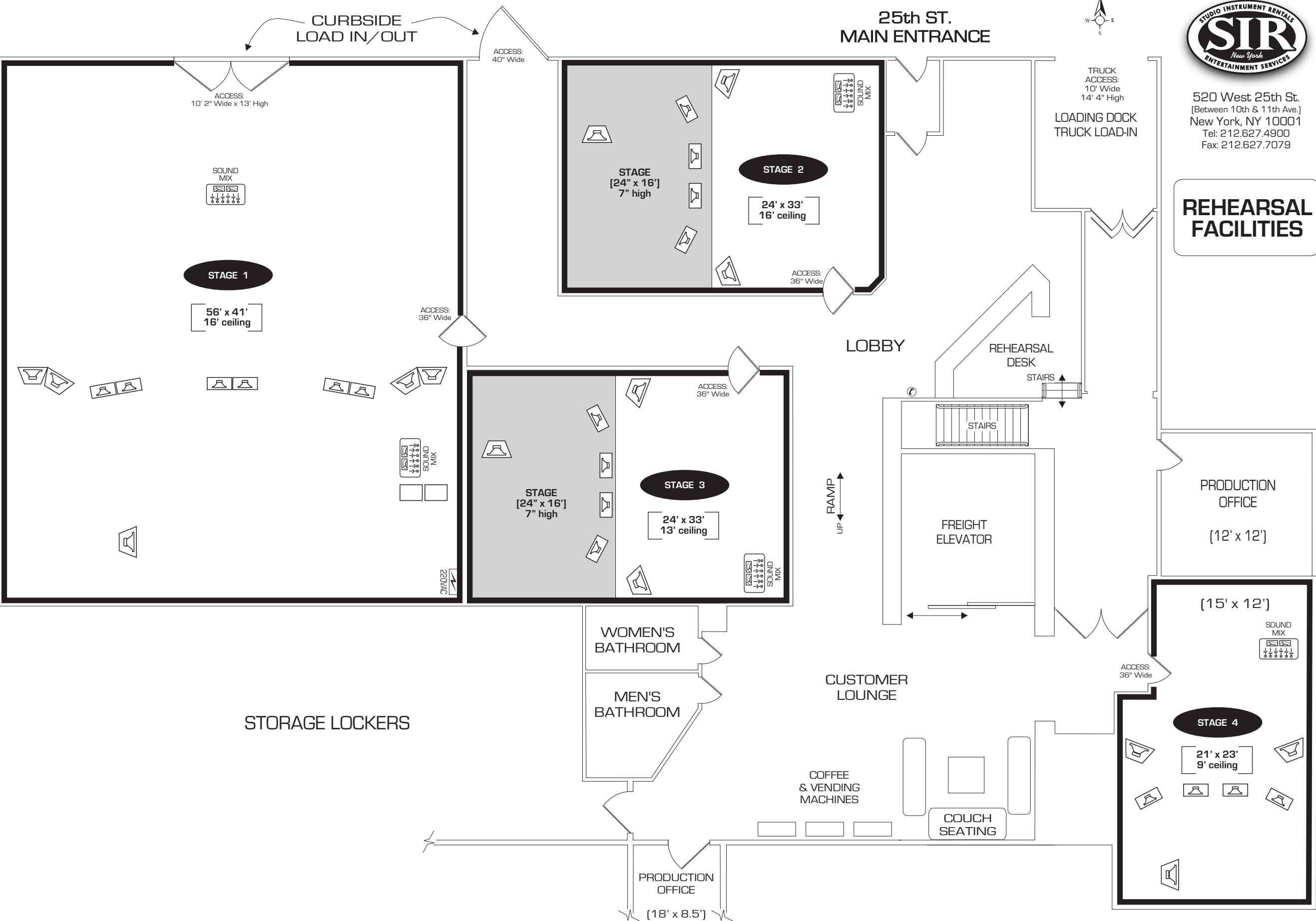

CURBSIDE  
LOAD IN/OUT

ACCESS:  
10' 2" Wide x 13' High

ACCESS:  
40" Wide

SOUND  
MIX

STAGE 1  
56' x 41'  
16' ceiling

ACCESS:  
36" Wide

STAGE  
[24' x 16']  
7" high

STAGE 2  
24' x 33'  
16' ceiling

ACCESS:  
36" Wide

LOBBY

REHEARSAL  
DESK

STAIRS

STAIRS

RAMP  
UP

FREIGHT  
ELEVATOR

PRODUCTION  
OFFICE  
(12' x 12')

STAGE  
[24' x 16']  
7" high

STAGE 3  
24' x 33'  
13' ceiling

ACCESS:  
36" Wide

SOUND  
MIX

STORAGE LOCKERS

WOMEN'S  
BATHROOM

MEN'S  
BATHROOM

CUSTOMER  
LOUNGE

COFFEE  
& VENDING  
MACHINES

COUCH  
SEATING

ACCESS:  
36" Wide

(15' x 12')

SOUND  
MIX

STAGE 4  
21' x 23'  
9' ceiling

PRODUCTION  
OFFICE  
(18' x 8.5')